

RT-147, 251, 320

MULTI-SPINDLE, MULTI FACEPLATE ROTARY TABLES

The RT-147, RT-251, and RT-320 have been designed for use on horizontal machining centers. The RT-147, RT-251, and RT-320 are available with dual or quad faceplates and can be accessorized with a swivel box for cable management. These tables are typically equipped with rotary joints for use in high production machining environments.



RT-147

Specifications

Dimensions = mm

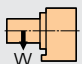
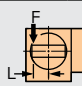
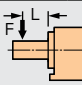
Table Model		RT-147	RT-251	RT-320
Table diameter		160 x (2,4)	200 x (2,4)	320 x (2,4)
Center height		135 & 315	135 & 385	210 & 610
Center bore	Nose Diameter	55H7	55H7	101H7
	Thru Diameter	40	40	130
Table T-slot width		12H8	12H8	12H8
Guide block width		14h7	14h7	14h7
Servo motor (Fanuc)*		Alpha 4i	Alpha 4i	Alpha 22i
Maximum motor speed rpm		4,000	4,000	3,000
Speed reduction ratio		1/90	1/90	1/90
Maximum table speed rpm		44.4	44.4	33.3
Inertia converted into motor shaft x 10 ⁻³ kg·m ²		.25	.25	3.04
Clamp system		Pneumatic	Hydraulic**	Hydraulic**
Clamp torque @72psi Nm (ft. lbs.)		156 (115)	-	-
Clamp torque @500psi Nm (ft. lbs.)		-	210 (154)	2,450 (1,806)
Indexing accuracy arc sec.		±12.5	±12.5	±12.5
Repeatability arc sec.		±2	±2	±2
Net Weight kg (lbs.)		100 (220) quad	135 (297) quad	450 (990) quad
Allowable wheel torque Nm (ft. lbs.)		147 (108)	264 (194)	931(686)
Allowable work inertia kg·m ²		.48	.48	5.12
Allowable work weight	 kg (lbs)	75/faceplate (165/faceplate)	75/faceplate (165/faceplate)	100/faceplate (220/faceplate)
Allowable load when table clamped	 Nm (ft. lbs.)	156 (115)	264 (194)	2,450 (1,806)
	 Nm (ft. lbs.)	392 (289)	392 (289)	3,626 (2,672)

*Other motors & rpm available • Specifications subject to change without notice • **Booster optional

Dimensions

Drawings not to scale • Dimensions = mm

RT-147

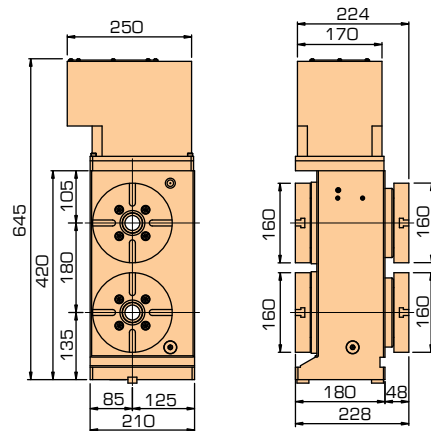

RT-251

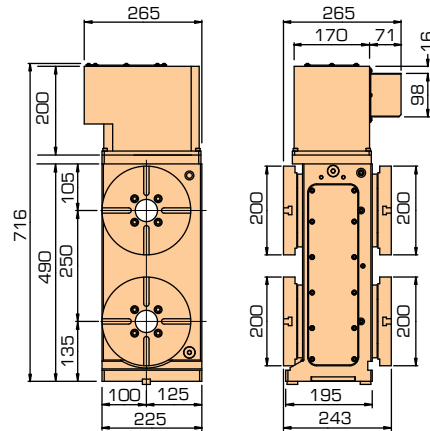

RT-320

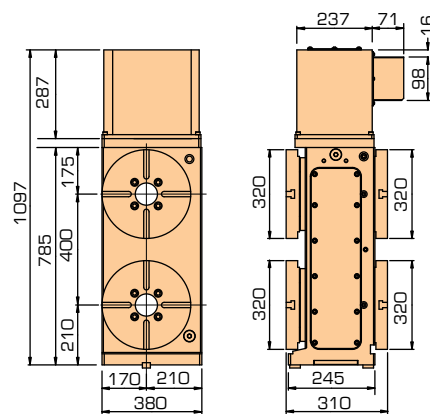

The dimensions above are for tables with a FANUC servo motor. Other motors available (dimensions may increase).

■ **RT-251**

The RT-251 shown below is a twin spindle, quad faceplate rotary table typically pallet mounted on a horizontal machining center. This table is equipped with an optional air/hydraulic booster and a swivel box for cable management.



OPTIONS • ACCESSORIES

Table Model	Quad Faceplates	TPC NC Controller	Various Chucks & Collets	Custom Swivel Boxes	PVC or Steel Braided Cables	Scales	Rotary Joint	Air/Hydraulic Booster
RT-147	Yes	TPC3 Series	Yes	Yes	Yes	Yes	Yes	No
RT-251	Yes	TPC3 Series	Yes	Yes	Yes	Yes	Yes	Yes
RT-320	Yes	TPC3 Series	Yes	Yes	Yes	Yes	Yes	Yes