

**RNE-160, 200, 250, 320 (NEW MODEL RWE-160, 200)**

COMPACT • MASSIVE CLAMP TORQUE



The RNE Series tables' offer speeds ranging from 25 to 44.4 RPM and indexing accuracies ranging from 10 to 12.5 arc seconds. These compact, high-speed, high-quality RNE Series tables offer economy line pricing while retaining high clamp torque and increased production performance.



RNE-160

**Specifications ►**

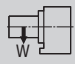
Dimensions = mm

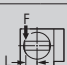
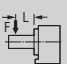
Table Model		RNE-160	RNE-200	RNE-250	RNE-320
Versions available		R, L	R, L	R, L	R, L
Spindle outer diameter	mm	100h7	120h7	140h7	180h7
Table diameter (optional)	mm	(160, 200)	(200, 250)	250	320
Center height	mm	135	160	160	210
Center bore	Nose Diameter	mm	55H7	65H7	75H7
	Thru Diameter	mm	40	45	45
Table T-slot width (with faceplate)		(12H8)	(12H8)	12H8	14H8
Guide block width		14h7	18h7	18h7	18h7
Servo motor*		Alpha 4i	Alpha 4i	Alpha 8i	Alpha 12i
Maximum motor speed	rpm	4,000	4,000	3,000	3,000
Speed reduction ratio		1/90	1/90	1/120	1/120
Maximum table speed	rpm	44.4	44.4	25	25
Inertia converted into motor shaft	x 10 <sup>-3</sup> kg·m <sup>2</sup>	.09	.17	.41	.52
Clamp system		Pneumatic Disc Clamp			
Clamp torque @72psi	Nm (ft. lbs.)	250 (180)	400 (295)	600 (442)	1,000 (737)
Indexing accuracy	arc sec.	±12.5	±10	±10	±10
Repeatability	arc sec.	±2	±2	±3.5	±3.5
Net Weight	kg (lbs.)	44 (97)	62 (136)	107 (235)	205 (451)
Allowable wheel torque	Nm (ft. lbs.)	206 (152)	288 (212)	565 (416)	939 (692)
Allowable work inertia	kg·m <sup>2</sup>	.48	1.25	1.95	3.77
Allowable work weight [with tailstock]	 kg (lbs)	75 (165) [150 (330)]	100 (220) [250 (550)]	100 (220) [250 (550)]	150 (330) [350 (770)]
	 kg (lbs)	150/330	250/550	250/550	350/770
Allowable load when table clamped	 Nm (ft. lbs.)	7,840 (1,762)	13,720 (3,085)	250 (550)	350 (770)
	 Nm (ft. lbs.)	250 (180)	400 (295)	13,720 (3,073)	19,600 (5,555)
	 Nm (ft. lbs.)	392 (290)	980 (723)	600 (442)	1,000 (737)

\* Other motors & RPM available  
Specifications subject to change without notice

Dimensions ▶

Drawings not to scale • Dimensions = mm

RNE-160

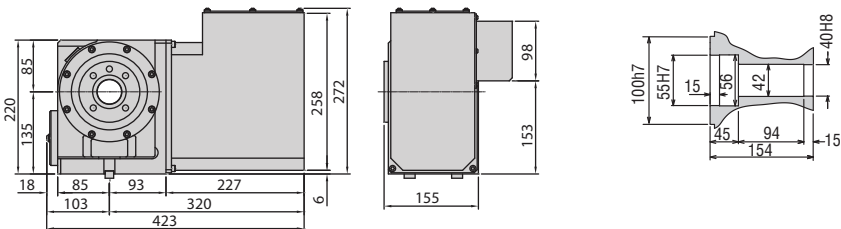

RNE-200

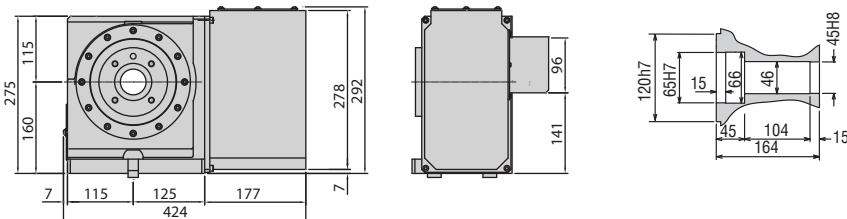

RNE-250

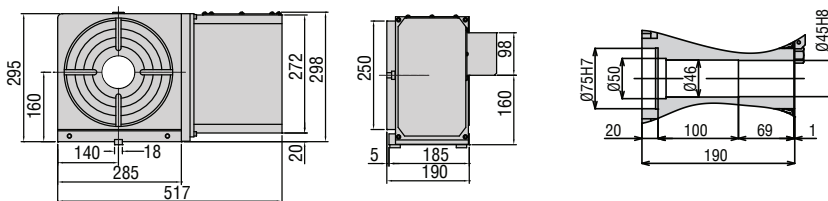

RNE-320

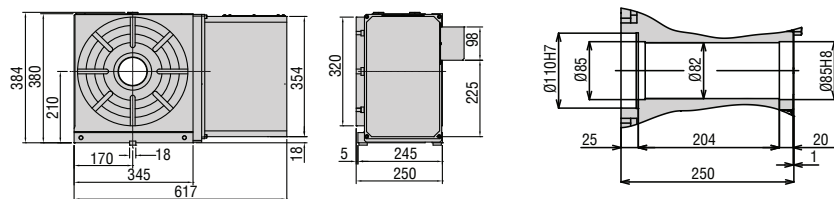

Options & Accessories

TPC NC Controller	
Chucks	
Tailstock	
Support Spindle	
Face Plate	
Encoder / Scale	
Pull Stud Device	
Rotary Joint	
PVC or Steel Cables	

The dimensions above are for tables with a FANUC servo motor. Other motors available (dimensions may increase).

Clamping Block and Bolt ▶

Dimensions = mm

	Type	Q'ty	T-Slot Width	A	B	C	D	E	F	G	H	I	J	K	L	M
RNE-160	-	2	14	-	-	-	-	-	-	-	17	8	60	-	23	12
RNE-200	-	2	18	-	-	-	-	-	-	-	21	11	65	-	28	16
RNE-250	I	4	18	25	12	80	12	33	35	22	21	11	65	40	28	16
RNE-320	I	4	18	30	15	90	16	31	43	25	21	11	70	46	28	16

Note 1: When using a machine with a T-slot pitch other than the above, use suitable clamping blocks and bolts that are available on the market, or order custom-made ones (opt.)

Note 2: Clamping blocks are not included in RNE-160 and RNE-200.

Type I

