

Rotary Axis Centered on Tilt Axis

Standard Features:

- 2 sizes: (6.5" and 10" rotary table diameters)
- Rotary and Tilt axis
- Dual lead wormset simplifies backlash adjustment
- C907 bronze wormgears and a hardened and ground worms running in a bath of oil
- High precision spindle bearings
- Turcite bearing surfaces
- Internal pneumatic brake (Rotary & Tilt)
- Precision ground surfaces
- Zero return / home switches (Both Axis)
- +/- overtravel limit switches (Tilt Axis)

Optional Features:

- Chucks – (Manual or Pneumatic)
- Collet fixtures - (Manual or Pneumatic)
- Single Axis programmable control
- Compatible with all standard servo motors
- Cables - for interfacing to machine tool
- Manual Rotary Axis and / or Manual Tilt Axis
- Ball Lock™ sub plate

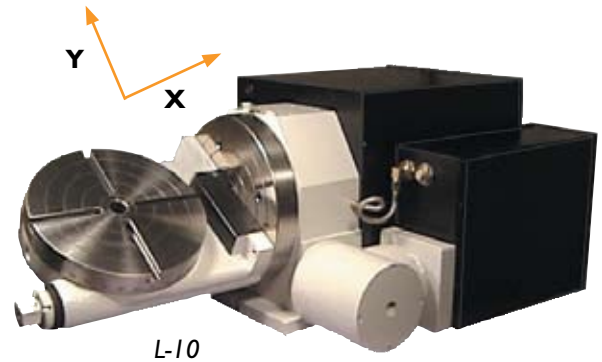
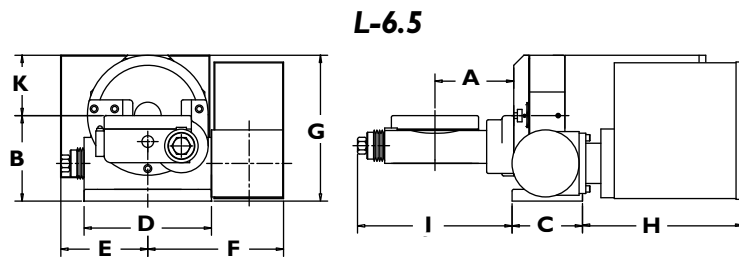

MODEL	A	B	C	D	E	F	G	H	J	K
L-6.5	5.88 [149]	6.38 [162]	5.25 [133]	9.50 [241]	6.43 [163]	10.25 [260]	13.87 [352]	13.50 [342]	11.56 [294]	4.50 [114]
L-10	7.50 [184]	7.00 [178]	7.25 [184]	10.25 [260]	7.25 [184]	10.25 [260]	15.25 [387]	14.87 [377]	14.25 [362]	4.00 [102]

SPECIFICATIONS - ROTARY AXIS			
MODEL		L-6.5	L-10
TURNTABLE DIAMETER	[MM]	6.5 [165]	10.0 [254]
STANDARD THRU HOLE DIA	[MM]	1.181 [30.0]	1.968 [50.0]
OVERSIZE THRU HOLE DIA	[MM]	*	*
MAXIMUM LOAD CAPACITY	[KG]	100 [45]	300 [136]
FACEPLATE T-SLOT WIDTH	[MM]	.47 [12] X 4	.47 [12] X 4
STANDARD TOTAL GEAR RATIO		80:1	180:1
MAX. SPEED RANGE (STD RATIO)		0-10 RPM	0-10 RPM
CONTINUOUS TORQUE	LBS-FT[NM]	94 [167]	375 [508]
BRAKE METHOD		N/A	PNEUMATIC
BRAKE TORQUE	LBS-FT [NM]	N/A	250 [338]
PROGRAMMABLE RESOLUTION		.001 DEG.	.001 DEG.
STD.TOTAL ANGULAR ACCURACY		+/-60 SEC.	+/-60 SEC.
STD.REPEATABILITY		+/-20 SEC.	+/-20 SEC.
UNIT WEIGHT	LBS [KG]	400 [179]	550 [247]
SHIP WEIGHT	LBS [KG]	475 [213]	625 [280]

SPECIFICATIONS - TILT AXIS			
MODEL		L-6.5	L-10
STANDARD TOTAL GEAR RATIO		240:1	180:1
MAX. SPEED RANGE (STD RATIO)		0-2 RPM	0-2 RPM
BRAKE METHOD		PNEUMATIC	PNEUMATIC
BRAKE TORQUE @ 100 PSI	LBS-FT [NM]	125 [169]	250 [338]
STD.TOTAL ANGULAR ACCURACY		+/-60 SEC.	+/-60 SEC.
STD.REPEATABILITY		+/- 30 SEC.	+/-30 SEC.
MAXIMUM TILT AXIS TRAVEL		+100/-20 DEG.	+100/-20 DEG.

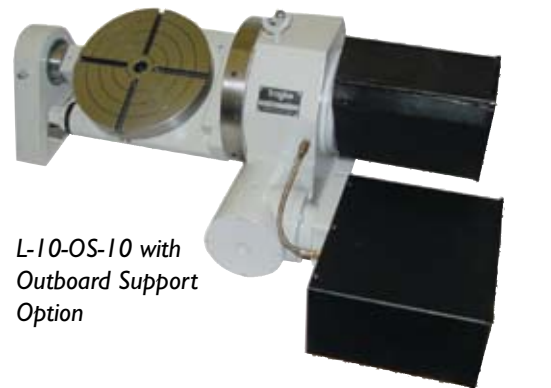

L-10-OS-10 with Outboard Support Option



TDL-8-2 with Dual Rotary Axis Option