

3 JAW SCROLL CHUCKS KITAGAWA NC ROTARY TABLES

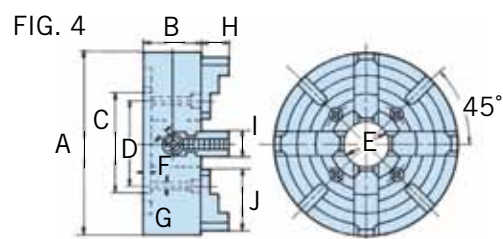
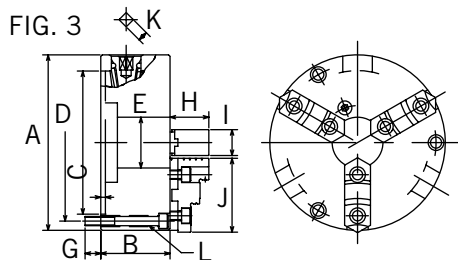
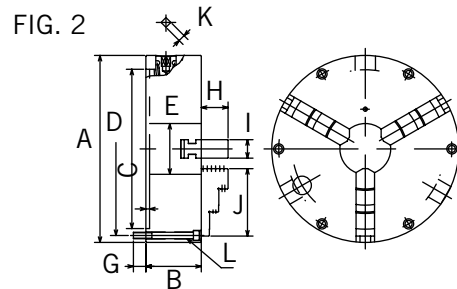
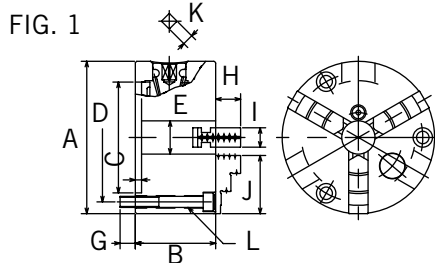

MODEL	KIW NO.	A	B	C	D	E
SC4T	SC-4-105	4.33	2.28	3.1496 H6	3.66	.94
SC5T	SC-5-107	5.12	2.36	3.9370 H6	4.45	1.26
SC6T	JN06T102	6.50	2.56	5.1181 H6	5.71	1.77
SC7T	JN07T102	7.48	2.95	6.1024 H6	6.69	2.17
SC9T	JN09T102	9.13	3.31	7.4803 H6	8.19	2.76
SC12T-4	JN12T131	12.20	3.78	10.2362 H6	11.10	4.13
SC14-6.1	SC-14-6.1	14.10	3.94	11.8110 H6	12.60	6.10
SC16	SC-16-113	15.94	4.72	13.5827 H6	14.76	4.33
SC21-12.6	—	21.06	4.45	15.7480 H7	19.68	12.60
IC21-13.6	—	21.06	4.50	15.7480 H7	17.32	13.62

F	G	H	I	J	K	L	FIG.
.18	.43	.71	.55	1.65	.31	3-M8	1
.18	.54	.79	.63	1.97	.31	3-M8	1
.20	.47	1.54	1.02	2.68	.39	3-M10	2
.20	.67	1.65	1.10	3.15	.43	3-M10	2
.24	.75	1.97	1.26	3.54	.47	3-M12	2
.28	.73	2.20	1.57	4.53	.55	3-M12	2
.17	1.08	3.03	1.50	5.00	.685	3-M16	3
.31	1.06	2.28	1.57	5.75	.59	6-M14	3
.20	1.10	3.30	1.65	5.04	.69	6-M16	3
.20	.71	4.00	1.94	5.06	3/4 HEX	8-M16	4

Note: SC-4T, 5T, 6T, 7T, 9T and 12T come with a set of reversible jaws and of soft jaws.

Note: SC-14 and 16 come with 2 sets of hardened solid jaws; 1 set of I.D. and of O.D. chucking jaws.

Note: SC-21-12.6 & IC-21-13.6 require optional mounting plate to mount on TP530. Add 1.064" to B Dimension to get the overall thickness of chuck. A mounting plate is furnished with scroll chuck when applicable. Specify rotary table model when ordering.

AIR CHUCKS FOR KITAGAWA NC ROTARY TABLES

- Cylinder built-in type, specifically designed for NC rotary tables
- Easy installation even on rear motor-mount rotary tables
- Repeatability within .0012" T.I.R.

SPECIFICATIONS

MODEL/KIW NO.	JAW TRAVEL (DIA.)	CLAMPING FORCE (LB. at 87 PSI)	MAX AIR PRESSURE (PSI)	SOFT JAWS	CHUCKING DIAMETER		MAX. R.P.M.	WEIGHT (LB.)
					MAX	MIN		
NRC04	.20	1686	101	SB04B1	4.33	.40	100	22
NRC06	.20	4020	101	SB06B1	6.49	.91	72	48.5
NRC08	.25	7283	101	SB08B1	8.26	1.19	60	61
NRC10	.25	10790	101	SB10A1	10.00	1.97	53	93.5

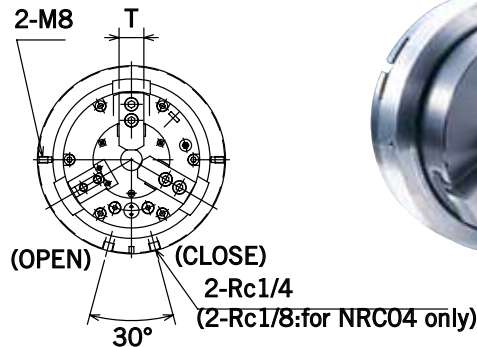
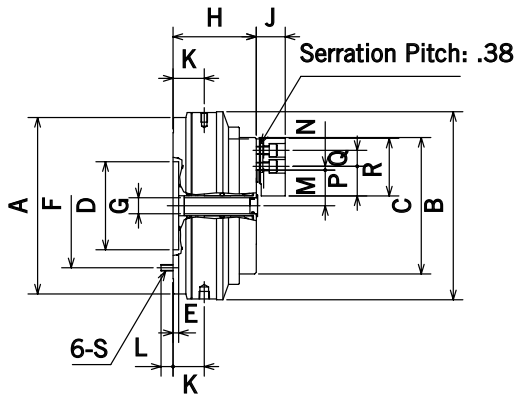

MODEL/KIW NO.	SIZE OF R. TABLE	A	B	C	D	E	F	G	H
NRC04	120, 160, 200	6.18	6.69	4.45	3.150 H7	.24	3.937	—	3.66
NRC06	160, 200, 250	8.68	9.25	6.71	4.331 H7	.28	6.102	.78	4.09
NRC08	250	10.47	11.02	8.5	4.331 H7	.31	7.874	1.18	4.61
NRC10	320	11.93	12.01	9.96	5.512 H7	.31	9.252	1.69	4.72

J	K	L	M(max)	M(min)	N(max)	N(min)	P	Q	R	S	T
1.06	1.30	.55	1.00	.90	.38	.27	1.10	.551	2.17	M6	.91
1.42	1.54	.59	1.75	1.65	.36	.19	1.46	.787	2.83	M8	1.22
1.65	1.63	.67	2.08	1.96	.58	.34	1.81	.984	3.74	M8	1.38
1.81	1.63	.83	2.59	2.47	.75	.33	1.97	1.181	4.33	M10	1.57

AIR CHUCKS FOR KITAGAWA NC ROTARY TABLES

ADAPTER PLATE MOUNTING ON NC ROTARY TABLES

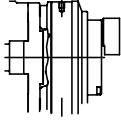
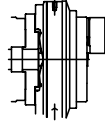
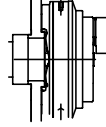
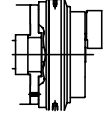
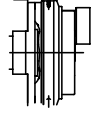
				
NRC04	NRC06	NRC06	NRC08	NRC10
TMX160 MR120 TMX200 MR160 TBX160 MR200 TBX200	TMX160 TBX200 TMX200 MR160 TBX160 MR200	TMX250 TBX250 MR250	TMX250 TBX250 MR250	TMX320 TBX320 MR320

Note: a mounting plate is furnished with air chuck when applicable. Specify rotary table model when ordering.

ACCESSORY CHART & RECOMMENDED LUBRICANT OIL FOR KITAGAWA ROTARY TABLES

MODEL/ KIW NO.	TAIL STOCK	AIR/HYDRAULIC TAILSTOCK	SCROLL CHUCK	AIR CHUCK	ROTARY JOINT	AIR BOOSTER	LUBE/OIL	
TT101	—	—	SC-4	—	RJ32H	—	MOBIL VACTRA NO. 1	
TT140			SC-4	—	RJ32TT140			
TT(TW)182			SC-6T	NRC06	RJ40FTT182			
TW2180			SC-6T	—	—			
TT(S)251			SC-9T	NRC08	RJ70H25T	AB25T		MOBIL VACTRA NO. 2
TT(S)321			SC-12T-4	NRC10	RJ70H32T			
TM-100-2R/ TM2100	TS100-2	TS100-2RSA	SC-4	—	RJ32H	MOBIL VACTRA NO. 1		
TM-100-3R/ TM3100	TS100-3	TS100-3RSA	SC-4		RJ32H			
TM-160-2R/ TM2160	TS160-2	TS160-2RSA(H)	SC-6T		NRC04		RJ40H	
TM-160-3R/ TM3160	TS160-3	TS160-3RSA(H)	SC-6T		NRC04		RJ40H	
TCM100	TS100	TS100-RSA	SC-4	NRC04	—		—	
TCM100A	TS100	TS100-RSA	SC-4	NRC04				
TCM2100A	TS100-2	TS100-2RSA	SC-4	—				
TCM3100A	TS100-3	TS100-3RSA	SC-4					
MRM120	TS160	TS160-RSA	SC-5	NRC04	—	—		
MRM160	TS200	TS200-RSA	SC-6T	NRC04				
MRM200	TS200	TS200-RSA	SC-7T	NRC06				
MRM250	TS250	TS250-RSA	SC-9T	NRC08				
MRM320	TS320	TS320-RSA	SC-12T-4	NRC10				

Technitron

Integration Services
www.technitron.com